



SPECIFIC DRILL PIPES

FEATURES

Our drill rods, welded by friction, are suited to work as well dth hammers as rotary and are mainly used for the vertical drilling.

COMPOSITION

- Our rods consist:
- N80 seamless steel tube
 - Friction welded tool joint with a heat treatment on the threads

TECHNICAL CHARACTERISTICS

MACHINE DRILLTECH T25/D25/D40

Diam. (mm) A	Thread	Thickness (mm) B	Length (mm) L				Dimensions (mm)					
			6010	6096	7620	9144	C	D	E	F	G	H
89	2"3/8IF	8	●	●			43	69.8	317.5	82.5	57	82.5
	2"3/8IF	12.5				●	43	69.8	317.5	82.5	57	82.5
102	2"3/8IF	8.8	●			●	43	69.8	317.5	82.5	57	82.5
	2"7/8REG	12			●	●	36	69.8	317.5	82.5	60	88.9
114	2"7/8IF	8.8		●	●		53	76.2	317.5	82.5	60	101.6
	3"1/2REG	8.8	●	●	●	●	53	76.2	317.5	82.5	60	101.6
	3"1/2REG	12.5			●	●	53	76.2	317.5	82.5	60	101.6

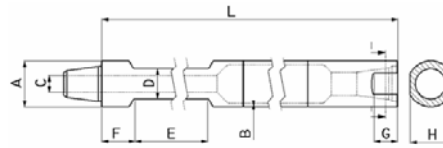

MACHINE IR T4

Diam. (mm) A	Thread	Thickness (mm) B	Length (mm) L			Dimensions (mm)								
			6096	7620	8077	9144	C	D	E	F	G	H	K	M
102	2"7/8REG	8.8		●		●	76	149	89	82	89	127	95	89
	2"7/8REG	19			●	●	76	149	89	89	89	127	95	89
114	2"7/8IF	8.8	●	●		●	76	149	89	89	89	127	86	101
	3"1/2REG	12.5				●	76	149	89	89	89	127	86	101
	3"1/2REG	19		●		●	76	149	89	89	89	127	86	101

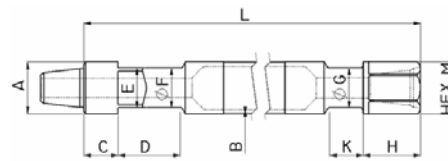

MACHINE IR TH60

Diam. (mm) A	Thread	Thickness (mm) B	Length (mm) L	Dimensions			
				6960	C	D	E
89	2"3/8IF	8.8	●	43	69.8	101.6	127
114	2"7/8IF	8.8	●	53	88.9	101.6	127
	3"1/2REG	8.8	●	43	88.9	101.6	127
	3"1/2FH	8.8	●	58	88.9	101.6	127
	3"1/2IF	8.8	●	58	88.9	101.6	127

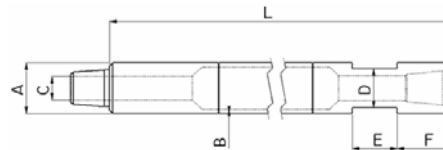

NOTE: other models of drill pipes on request



34, rue des Châteliers
BP 2803
45028 Orléans Cedex 1
Téléphone : 02 38 86 50 46
Télécopie : 02 38 86 78 91
Email : stenuick@stenuick.fr
Site : www.stenuick.fr

IMPORTANT:
The technical characteristics can be modified without notice

CATEGORY

Drilling equipment